

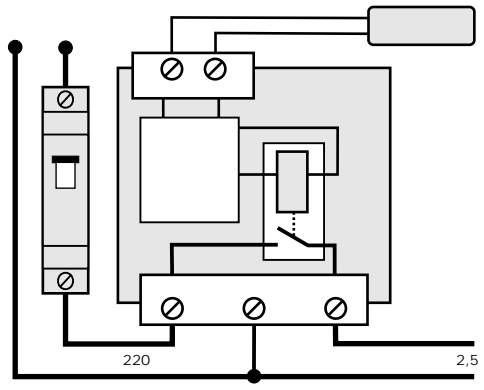

-16n

3. ---.



(20).

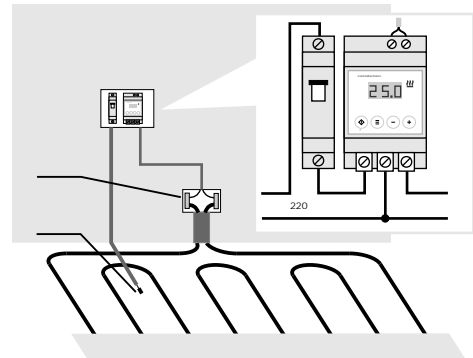

4. ÿ 3aãf öf àèà àf öf àf öè

(---). 2

2 ()

1. (), 3- (25.0).

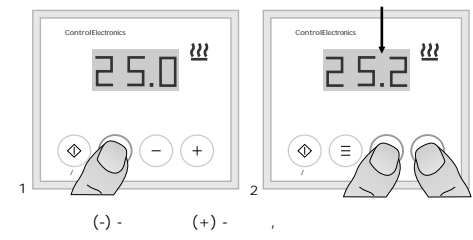

1 (-) - (+) - 2. (-) (+)

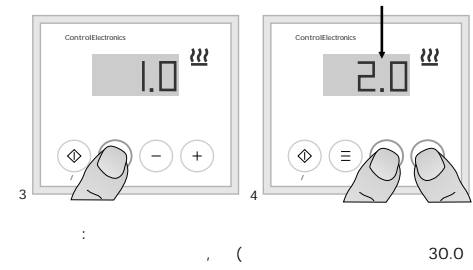

1 29.0 5 25.0 ()

5. ---

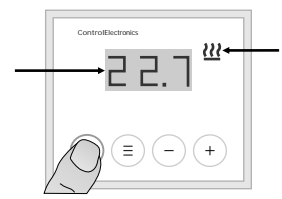

(/)

(/)

5. ---

1. Çaaã öf ÿ öbuny öf öèàöeny ààò-èèà à öf àf =f) ó noaf³, f) önéàöè ö³aef ó àaç f àa³ef f; à³aöf - àèàéöü³ çf eyö³!

2. Ç 3. 4. 2.5

6. ---

24

1. 2. () 3. 4. 5.

" " 201

(/)

()

()

()

()

1. ÿ öèçf à-àf ÿ öa f öèf öèf öf àf öè

DIN-

2. 3 f 3

1. 3 200 - 240
2. 0°Ñ... +50°Ñ 0,1°Ñ
3. 2,5
4. 0,5°Ñ
5. 1°Ñ... 10°Ñ 1°Ñ
6. DS18B20
7. 2
8. 20
9. 90x70x54
10. Ip20